

DVV-13Z

TORQUE MULTIPLIER DREMOPLUS ALU

1300Nm / 950lbf·ft

3/4"

±3%

0000000000



Particularly suitable for:

- > Industry, construction sites, car and truck garages, agricultural technology.
- > Bridge, aircraft and railway construction, ship building, refineries.
- > Machinery and plant engineering, maintenance.

Features:

- > Mechanical hand torque multiplier for controlled screw tightening and loosening screw connections.
- > With a single-stage planet gear.
- > High-performance aluminium housing.
- > With Z-form offset reaction arm of Chrome Vanadium steel.
- > Can be optionally retrofitted with L-form straight reaction arm – with adjustable reaction arm – of lightweight metal.
- > Multiplication at the ratio of 1:5.
- > Guaranteed accuracy: Better than +/- 3% tolerance.
- > For operation in combination with a torque wrench.
- > 1 model for a maximum load of around a maximum 1300Nm.
- > Also available as set (No. DVV-13ZG) with three different impact sockets – sizes 27, 30, 32mm.
- > Output square with drill hole for impact sockets with safety pin and ring.

Scope of delivery:

- > Torque Multiplier DREMOPLUS ALU.
- > With Z-form offset reaction arm.
- > Delivery in sturdy shipping case with foam insert.
- > Factory test certificate and setting table.
- > Detailed technical information is available on request.



DVV-13Z



DVV-13ZG

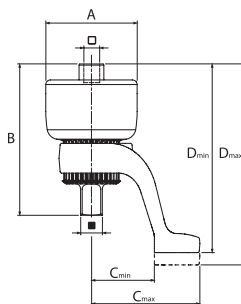

DVV-13Z

Code	No.	max. Nm Output	max. lbf-ft Output	1:5	"C	"D	A	B	C _{min}	C _{max}	D _{min}	D _{max}	max. Nm Input	max. lbf-ft Input	kg
2653370	DVV-13Z	1300	950	1:5	1/2	3/4	80	133	56	95	165	173	270	200	1.9

OPTIONAL ACCESSORIES

Code	No.	Description	A	B	C _{min}	C _{max}	kg
2653400	RL-DVV13	Reaction arm L-form straight for DVV-13, 3/4"	80	133	60	159	0.800